

Lower Ground Floor

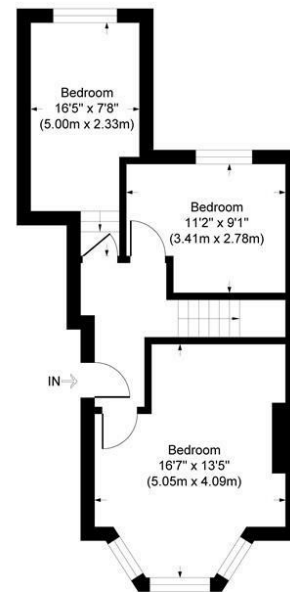

Ground Floor



## Urswick Road

Approximate Gross Internal Area  
 Lower Ground Floor = 42.8 sq m / 462 sq ft  
 Ground Floor = 43.2 sq m / 465 sq ft  
 Total = 86.1 sq m / 927 sq ft

This plan is for layout guidance only. Not drawn to scale unless stated. Windows and door openings are approximate. Whilst every care is taken in the preparation of this plan, please check all dimensions, shapes and compass bearings before making any decisions reliant upon them.

powered by:  
**THE360IMAGE**  
[www.the360image.co.uk](http://www.the360image.co.uk)



## Directions

## Contact

125 Hoe Street  
 London  
 E17 4RX

E: [lettings@hcolondon.com](mailto:lettings@hcolondon.com)

T: 02085 210 755

[hcolondon.com](http://hcolondon.com)



3 Bed  
 Flat  
 located in





Flat A,  
15 Urswick  
Road  
  
London

£3,000 PCM



THREE BEDROOM FLAT --- AVAILABLE FROM THE 14TH OCTOBER --- VICTORIAN CONVERSION --- PART - FURNISHED -  
-- MASSIVE BACK GARDEN --- DOUBLE GLAZED & GAS CENTRAL HEATING --- LAMINATE FLOORING --- ONE  
BATHROOM --- SPLIT OVER TWO LEVELS

London's Local Property Agent, Humphrey & Co Estates present to the rental market this three double bedroom ground floor/basement flat. The property compromises of a very large kitchen and reception leading to the garden in the basement. Laminated flooring in all the rooms, neutral décor and very high ceilings. The property is on the ground floor and basement. Gas central heating and double glazing throughout. Please call our lettings team to secure a viewing on this property.

Summary

London's Local Property Agent, Humphrey & Co Estates present  
to the rental market this three double bedroom ground floor/basement flat. The  
property compromises of a very large kitchen and reception leading to the  
garden in the basement. Laminated flooring in all the rooms,  
neutral decor and  
very high ceilings. The property is on the ground floor and basement. Gas  
central heating and double glazing throughout. Please call our  
lettings team to  
secure a viewing on this property.

